



Huntington 3 Series

HTG-3PR

REGRESS PERIMETER

Brilliant by Design™, the Huntington 3 Regress Perimeter is a precisely engineered, 3” regressed solution to meet the complexity of illuminating the connection of the ceiling and wall. Our patented Microstructure EdgeTech Optics™ (MEO) technology delivers unparalleled optic control, low glare visual comfort, exceptional performance, seamless illumination, and uniformity in unprecedented low-profile behind ceiling depths. Lens gaps, pixelation and hot spots are a thing of the past with our innovative Dual Lens Edge-lit MEO™ technology.

FEATURES

- Available in Trimless, Trim Flange, and T-Grid mounting options.
- Multi-depth ceiling options for use in most plenum installations:
 - 1.75” Regress: 5.75” - 6.13” Depth
 - 3” Regress: 7” - 7.38” Depth
- Design without compromise: Glare Control, Diffused (Lambertian) or Grazer Optics
- Specified Lumen Outputs (SLO) available: 127 lm/ft – 975 lm/ft
- Minimalistic 3” Aperture
- Individual fixture lengths and seamless continuous runs with no lens breaks up to 300 feet
- Fixed housing and Field Cuttable options available
- Drivers, wiring and serviceability completely accessible from below ceiling with our patented toolless “Push to Eject” system
- Toolless Latch System and Quick-Click 5 Wire system allows for simple, quick, and seamless installation
- Proudly crafted in Huntington Beach, CA - USA



PERIMETER

Performance Overview

4' Huntington 3 - 3500K 90CRI MEODF				
Lumen Output	LL (Low)	ML (Medium)	HL (High)	SLO* (Specified)
Delivered Lumens	508	1256	2476	508-3900
Consumed Wattage	7	18	38	7-66
Efficacy (lm/W)	73	70	65	59-73
SDCM	3	3	3	3

*Specified Lumen Output (SLO) available in customizable lumen configurations (896 lm - 6852 lm). See SLO Configurator on product page.



ORDERING INFORMATION

EXAMPLE: HTG-3PR-TD-RG3-FHT-TFWP-108"-DLL-GRZ-27-VU-D

Project: _____

Date: _____ Type: _____

Product Family	Lens Position	Housing Type	Trim	Length	Lumen Output
HTG-3PR-TD Huntington Series 3" Aperture Perimeter Integral Driver	RG1 1.75" Regress RG3 3" Regress	FHT* Fixed Housing FCW** Field Cuttable PC Custom Pattern - Submit Drawings (Inside/Outside corners)	TRIM FLANGE TFSA Trim Flange - Silver Anodized TFWP Trim Flange - Matte White TFBP Trim Flange - Matte Black TFCC Trim Flange - Custom Color TRIMLESS SF Spackle Flange (Mud-in) T-GRID L1* 15/16" Grid Lay-in System L9* 9/16" Grid Lay-in System T1* 15/16" Grid Tegular System T9* 9/16" Grid Tegular System SB* Bolt Slot Grid System AI* Armstrong Interlude/USG Identitee	____ * Specify length	DLL Low (127 l/ft @ 1.75 W)* DML Medium (314 l/ft @ 4.5 W)* DHL High (619 l/ft @ 9.5 W)* SLO-XX Specified Lumen Output available.** (127 lm/ft - 975 lm/ft)
	Flush Lens options available in HTG-1PR-LP & HTG-3PR-LP Series. For details see www.ExtantLighting.com	*FHT will have end caps. Not recommended for precise installations. Specify in 3" increments. **FCW will not have visible end caps at wall. (2) 6" field cuttable end pieces provided for wall to wall applications.	*White finish is standard on all T-Grid (Suspended Ceiling) trim options (L1, L9, T1, T9, SB and AI)	* FHT - Fixed Housing Trim must be specified in 3" increments. (Not recommended for wall to wall applications). * FCW - Field Cuttable option must be specified in exact length from wall to wall (i.e. 421"). Factory will take this exact length and shorten lit section by up to 3" on each side and provide (2) 6" field cuttable end pieces to provide proper wall to wall distances and light distribution.	*Delivered lumen output & consumed wattage based on "MEODF 35" (90 CRI - 3500K). See SLO Configurator for alternate outputs. **See SLO Configurator at ExtantLighting.com for appropriate "xx" output.

Optics	Color Temp	Voltage	Driver	Options
MEO MEODF Diffusing MEOGC Glare Control PRO GRZSH* Grazer with Shielding Lens GRZ* Grazer (No Shielding Lens)	27 2700K 30 3000K 35 3500K 40 4000K 50 5000K TW 2700K-6500K (85+ CRI) XX Optional Color Temp & CRI Available	VU 120V-277V V3* 347V	D* 1% 0-10V DN NON DIM DL1 Lutron Hi-Lume 1% EcoSystem DE .1% 0-10V DD1 .1% DALI DDE .1% DALI DMX/RDM .1% DMX/RDM DTW .1% 0-10V Tunable White DDTW .1% DALI Tunable White DELV .1% Electronic Low Voltage Dimming (Reverse Phase dimming) DTRIAC .1% Electronic Low Voltage Dimming (Forward Phase dimming) XX Other (Please Specify)	EMC_* Emergency Circuit(s) EMB_* Emergency Battery Pack(s) BCS* Brilliant Communications Solutions (wired/wireless)
*Grazer optics only available with RG3 Lens Position.		*Only available with D and DN Drivers.	*Dim to Off available. Please Specify "-OFF" next to driver option if required.	*EMC: Specify quantity of emergency circuits. *EMB: Specify quantity of battery packs. Minimum 4' unit. *BCS: includes wired and wireless integration from our partners at nLight™, enlightened, Legrand, Crestron, Osram, Lutron and many more. Contact Extant for details.



Specifications

CONSTRUCTION Heavy gauge 6063 extruded aluminum housing.

OPTICS Microstructure EdgeTech Optics (MEO)™ utilizes high efficiency Microstructure Lenses and Light Guide Plates for high optical extraction and precise light management. Specify Glare Control, Diffused (Lambertian), or Graze Optics.

LIGHT OUTPUT (3) Standard lumen packages are available: Low (DLL), Medium (DML) and High (DHL). Specified Lumen Output (SLO) packages available. Please see the (SLO) configurator at ExtantLighting.com.

LEDS Latest generation of premium Nichia 3-step MacAdam Ellipse LED's available in (90+ CRI) 2700K, 3000K, 3500K, 4000K accessible and replaceable.

VOLTAGE Universal 120/277V (VU) and 347V (V3) available. Consult factory for driver options when 347V is specified.

EMERGENCY BATTERY Factory provided low profile 10W battery for UL924 required 90-minute run time (optional).

FINISH Standard finish is powder coated white for all trim option. Custom colors available.

CONTINUOUS ROWS Innovative Toolless Latch System and Quick-Click 5-Wire System ensures simple installation. Seamless continuous rows with no lens breaks, pixelation or hot spots up to 300 feet.

PATTERNS Custom shapes and inside/outside mitered corners available.

MOUNTING Perimeter Spackle Flange, 15/16" or 9/16" Grid Lay-in, 15/16" or 9/16" Grid Tegular, Bolt Slot or Armstrong Interlude/USG Identitee.

APPROVALS UL and cUL Listed. Approved for Dry/Damp locations. IC Rated. Made in the USA. Chicago Plenum Approved. JA8 Approved.

LUMEN MAINTENANCE (L70) 70% of initial light output = Reported > 60,000 hours | Calculated > 200,000 hours (L90) 90% of initial light output = Reported > 60,000 hours | Calculated > 200,000 hours.

LENS POSITION 3" Regressed Lens or 1.75" Regress Lens available. Flush Lens available in HTG-1PR-LP and HTG-3PR-LP Series.

WARRANTY HTG 3 offered with a 5-year limited warranty. 5-year limited warranty covers LED, driver and fixture. For further details, refer to General Warranty and Obligations at ExtantLighting.com.

PATENTS Extant Lighting's intellectual property is protected under Patent No. US 11,378,262 B2 by the U.S. Patent Office.

Dimensions

Note: PRSB Trim option shown above. Contact factory for alternate trim option dimensional drawings (PRSF, PRL1, PRL9, PRT1, PRT9, PRA1)

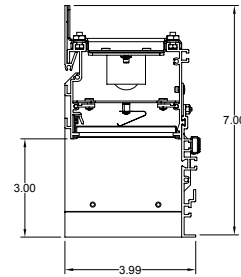

TF

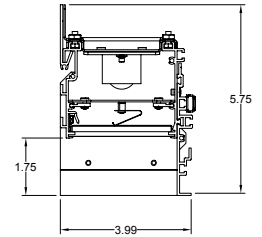

TF

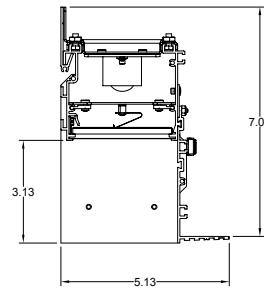

SF

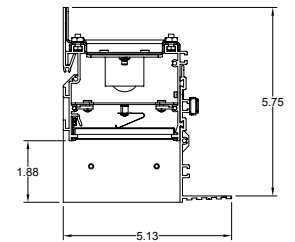

SF

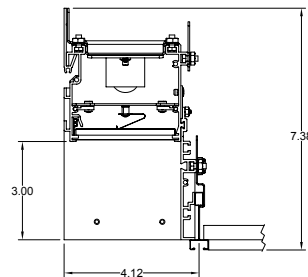

SB

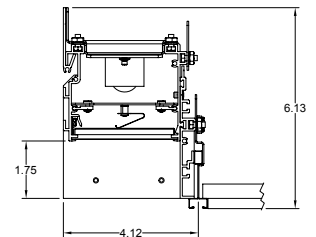

SB

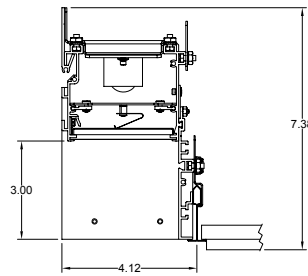

T9

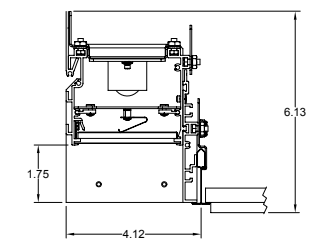

T9



Dimensions Cont.

Note: PRSB Trim option shown above. Contact factory for alternate trim option dimensional drawings (PRSF, PRL1, PRL9, PRT1, PRT9, PRA1)

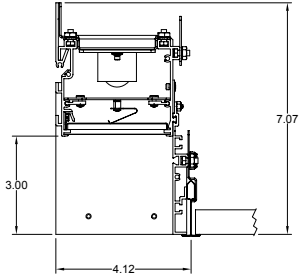

L9

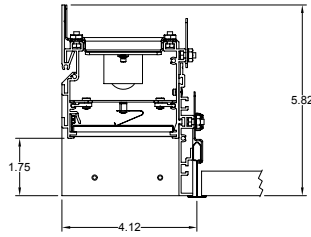

L9

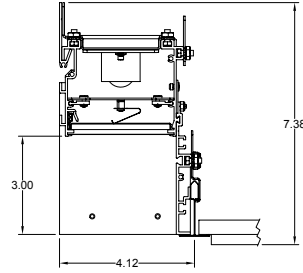

T1

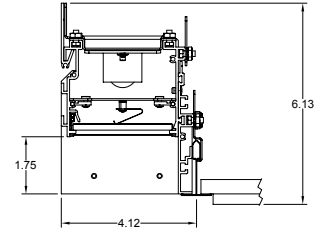

T1

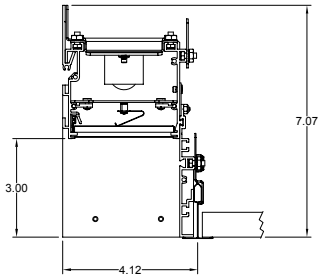

L1

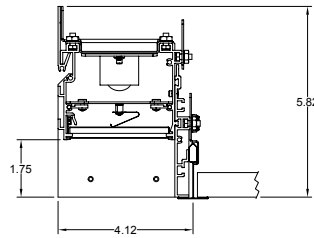

L1



Microstructure EdgeTech Optics (MEO)™

Our innovative MEO™ design utilizes high efficiency Microstructure Lenses and Light Guide Plates for high optical extraction and precise light management. MEO™ delivers exceptional light quality with seamless illumination and uniformity with no pixelation, hot spots or lens breaks up to 300' continuous rows.

DIRECT

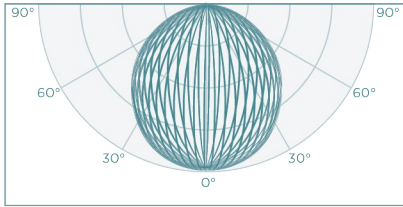

MEODF
LAMBERTIAN

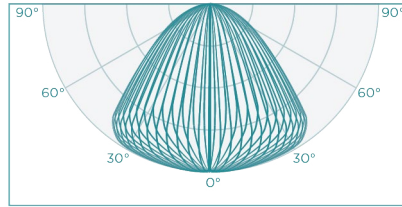

MEOGC
GLARE CONTROL

Precision Refractive Optics (PRO)

Precision Refractive Optics (PRO) are designed to produce precise optic control for diverse design applications. PRO Optics in the perimeter system are only used for the Grazer optics. The PRO optic utilizes the latest in extruded lens technology that mount directly to the LED board channel to give optimum control and a precision Grazer optic.

Please Note: The GRZ and GRZSH optic is only available in the RG3 (Regressed 3") Option.

DIRECT

GRZ
GRAZER (NO SHIELDING LENS)

GRZSH
GRAZER WITH SHIELDING LENS

Contact factory for more information.



Continuous Row Detail

NOTE: For additional Continuous Row Detail, please visit ExtantLighting.com

Nominal Row Length (ft)	Segment Lengths (ft)	Overall Row Length
9	5 + 4	9' 1/2"
10	6 + 4	10' 1/2"
11	7 + 4	11' 1/2"
12	8 + 4	12' 1/2"
13	8 + 5	13' 1/2"
14	8 + 6	14' 1/2"
15	8 + 7	15' 1/2"
16	8 + 8	16' 1/2"
17	8 + 5 + 4	17' 1/2"
18	8 + 6 + 4	18' 1/2"
19	8 + 7 + 4	19' 1/2"
20	8 + 8 + 4	20' 1/2"
21	8 + 8 + 5	21' 1/2"
22	8 + 8 + 6	22' 1/2"
23	8 + 8 + 7	23' 1/2"
24	8 + 8 + 8	24' 1/2"
25	8 + 8 + 5 + 4	25' 1/2"
26	8 + 8 + 6 + 4	26' 1/2"
27	8 + 8 + 7 + 4	27' 1/2"
28	8 + 8 + 8 + 4	28' 1/2"
29	8 + 8 + 8 + 5	29' 1/2"
30	8 + 8 + 8 + 6	30' 1/2"
31	8 + 8 + 8 + 7	31' 1/2"
32	8 + 8 + 8 + 8	32' 1/2"
33	8 + 8 + 8 + 5 + 4	33' 1/2"
34	8 + 8 + 8 + 6 + 4	34' 1/2"
35	8 + 8 + 8 + 7 + 4	35' 1/2"
36	8 + 8 + 8 + 8 + 4	36' 1/2"
37	8 + 8 + 8 + 8 + 5	37' 1/2"
38	8 + 8 + 8 + 8 + 6	38' 1/2"
39	8 + 8 + 8 + 8 + 7	39' 1/2"
40	8 + 8 + 8 + 8 + 8	40' 1/2"
41	8 + 8 + 8 + 8 + 5 + 4	41' 1/2"
42	8 + 8 + 8 + 8 + 6 + 4	42' 1/2"
43	8 + 8 + 8 + 8 + 7 + 4	43' 1/2"
44	8 + 8 + 8 + 8 + 8 + 4	44' 1/2"
45	8 + 8 + 8 + 8 + 8 + 5	45' 1/2"
46	8 + 8 + 8 + 8 + 8 + 6	46' 1/2"
47	8 + 8 + 8 + 8 + 8 + 7	47' 1/2"
48	8 + 8 + 8 + 8 + 8 + 8	48' 1/2"

Field Cuttable Housing Type Detail

NOTE: It is recommended to leave 2" - 3" between end caps and adjacent walls to reduce overlighting the walls. See instructions at ExtantLighting.com for more details.

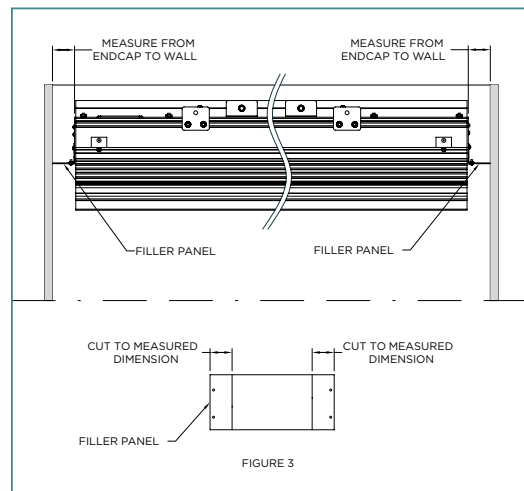
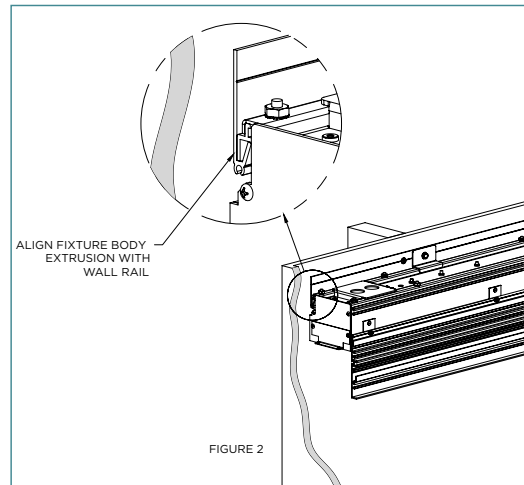
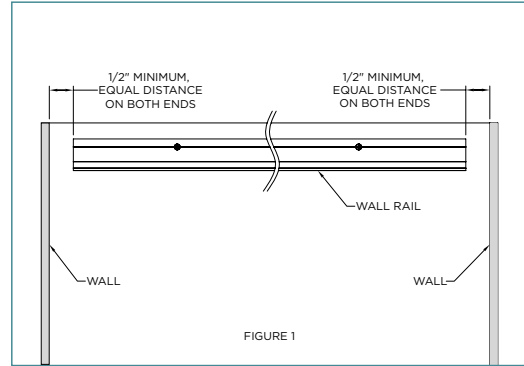

Installation

Thoughtful engineering is at the core of all of our fixture designs. All of our products are thoughtfully engineered and include innovative features that create a sophisticated fixture that is also contractor friendly and easy to install and service.

PUSH TO EJECT SYSTEM

Innovative “Push to Eject” System allows for toolless removal and installation of the Light Guide Plate. This thoughtful engineering creates easy access into the housing for simple installation and serviceability.

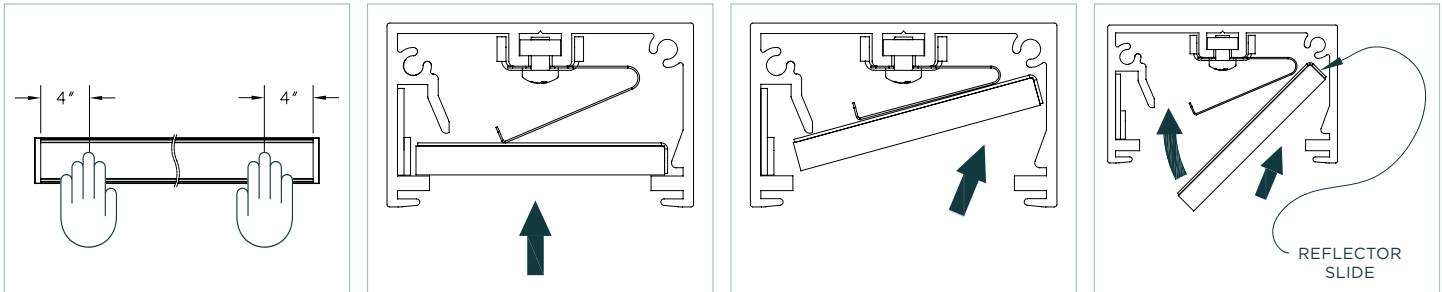

TOOLLESS LATCH SYSTEM

Our Toolless Latch System is designed to securely connect the extrusions of the continuous runs without the use of any tools, screws or external parts. Our innovative design allows the contractor to perfectly align the extrusion with the built-in alignment pins and cinch up the extrusion with the Toolless Latch System for a tight fit. The Toolless Latch System eliminates gaps and ensures perfect alignment.

QUICK-CLICK 5-WIRE SYSTEM

Our Quick-Click 5-Wire System connects the continuous run through wiring with a simple push and click connection. The Quick-Click System is contractor friendly and decreases installation time and cost and ensures proper wiring.

