



Huntington 1 Series

# HTG-1P-PDS

SUSPENDED - POWER DOWN SUSPENSION

Brilliant by Design™, minimalistic aesthetic combined with our innovative Microstructure EdgeTech Optics (MEO)™ will bring your vision to light. The innovative MEO™ design utilizes high efficiency Microstructure Lenses and Light Guide Plates for high optical extraction and precise light management.

## FEATURES

- Innovative Microstructure EdgeTech Optics™ delivers unparalleled optic control and exceptional performance with seamless illumination and uniformity. Specify Batwing, Glare Control, Diffused (Lambertian), Wall Wash, or Room Fill Optics.
- 1/8" Silver Power Cord with Chrome-Plated Connectors.
  - Carries a Positive and Negative Wire within the 1/8" cord.
  - Up to 10' from the canopy to fixture.
  - Both sides match for Architectural Elegance.
- MEO™ allows for minimalistic 1.5" Aperture fixtures with extremely low profiles.
- Individual fixture lengths and seamless continuous rows with no lens breaks, pixelation or hot spots up to 400 feet.
- Innovative Toolless "Push to Eject" System allows for easy installation and serviceability.
- The Power Down Suspension system removes the extra power cord allowing for clean and elegant mounting.
- Custom powder coat and anodized finishes.
- Specified Lumen Outputs (SLO) and Tunable White LED's available.
- Proudly crafted in Huntington Beach, CA - USA.



SUSPENDED

## Performance Overview

4' Huntington 1 Direct - 3500K 90 CRI MEODF				
Lumen Output	LL (Low)	ML (Medium)	HL (High)	SLO* (Specified)
Delivered Lumens	772	1908	3760	772-3760
Consumed Wattage	7	18	38	7.36-38
Efficacy (lm/W)	105	105	99	90-105
SDCM	3	3	3	3

\*Specified Lumen Output (SLO) available in customizable lumen configurations. See SLO Configurator [HERE](#)



**ORDERING INFORMATION**

Project: \_\_\_\_\_

Date: \_\_\_\_\_ Type: \_\_\_\_\_

Product Family	Driver Location	Mounting Direction	Length	Lumen Output	Color Temp
<b>HTG-1P</b> HTG-1P Huntington Series 1.5" Aperture (Suspended)	<b>RD</b> RD Remote Driver	<b>DT</b> DT Direct	<p>____* Specify length in 1 foot increments</p> <p><b>R_X_</b> Rectangle <b>L_X_L</b> L Pattern <b>U_X_X_</b> U Pattern</p> <p>*Minimum Integral Driver length is 2'. Minimum Remote can be shorter, consult factory. *Custom length fixtures can be ordered in 3" increments. *Any length over 8' requires multiple fixture segments.</p>	<p><b>DLL</b> Low (193 l/ft @ 1.84 W)* <b>DML</b> Medium (477 l/ft @ 4.55 W)* <b>DHL**</b> High (940 l/ft @ 9.46 W)* <b>SLO-XX</b> Specified Lumen Output available.***</p> <p>*Delivered lumen output &amp; consumed wattage based on "MEODF 35" (90 CRI - 3500K). See SLO Configurator for alternate outputs. **See SLO Configurator at <a href="http://ExtantLighting.com">ExtantLighting.com</a> for appropriate "XX" output. **DHL is the highest output for PDS System ***DELV &amp; DTRIAC Drivers only available up to SLO-18.</p>	<p><b>27</b> 2700K <b>30</b> 3000K <b>35</b> 3500K <b>40</b> 4000K <b>50</b> 5000K <b>XX</b> Optional Color Temp &amp; CRI Available</p> <p>*Contact factory for driver compatibility with TW</p>

Optics	Voltage	Driver	Finish	Options	Mounting
<p><b>MEO</b> <b>MEODF</b> Diffusing <b>MEOBW</b> Batwing <b>MEOGC</b> Glare Control <b>MEORF</b> Room Fill <b>MEOWW</b> Wall Wash</p>	<b>VU</b> VU 120V-277V	<p><b>D*</b> 1% 0-10V <b>DN</b> NON DIM <b>DELV**</b> 1% Electronic Low Voltage Dimming (Reverse Phase dimming) <b>DTRIAC**</b> 1% Electronic Low Voltage Dimming (Forward Phase dimming) <b>DL1</b> Lutron Hi-Lume 1% EcoSystem <b>DE</b> 1% 0-10V <b>DD1</b> 1% DALI <b>DDE</b> 1% DALI <b>DMX</b> 1% DMX/RDM <b>XX</b> Other (Please Specify)</p> <p>*Dim to Off available. Please Specify "-OFF" next to driver option if required. **Only available up to SLO-18.</p>	<p><b>SA*</b> Silver Anodized <b>WP*</b> Matte White <b>BP*</b> Matte Black <b>CC**</b> Custom <b>SAMF</b> SA Housing/Machine Finish End Caps <b>WPMF</b> WP Housing/Machine Finish End Caps <b>BPMF</b> BP Housing/Machine Finish End Caps <b>CCMF</b> CC Housing/Machine Finish End Caps</p> <p>*The housing finish and end cap finish will match. ** Custom Color (CC) to be provided in satin finish and color to be specified by a RAL number. The housing finish and end cap finish will match.</p>	<p><b>EMB_*</b> Emergency Battery Pack(s) <b>JAB</b> JAB Compliant</p> <p>*EMB: Specify quantity of battery packs. Minimum 4' unit. PDS System is compatible with sensors/wired/wireless communication systems. Please consult factory.</p>	<b>PDS</b> PDS Power Down Suspension

Cable Length	Power Cord	Canopy Mounting	Canopy Shape/Finish
	<b>SL</b>		
<p><b>24</b> 24" <b>48</b> 48" <b>72</b> 72" <b>96</b> 96" <b>120</b> 120"</p> <p>All cables are fully adjustable</p>	<b>SL</b> Silver	<b>C5</b> 5" Canopies - JBox (Standard)	<p><b>SQS</b> Square Silver <b>SQW</b> Square Matte White <b>SQB</b> Square Matte Black <b>RNS</b> Round Silver <b>RNW</b> Round Matte White <b>RNB</b> Round Matte Black</p>



### Specifications

**CONSTRUCTION** One-piece heavy gauge 6063 extruded aluminum housing. Precision-machined aluminum end caps.

**OPTICS** Microstructure EdgeTech Optics (MEO)™ utilizes high efficiency Microstructure Lenses and Light Guide Plates for high optical extraction and precise light management. Specify Batwing, Glare Control, Diffused (Lambertian), Wall Wash, or Room Fill Optics.

**LIGHT OUTPUT** (3) Standard lumen packages are available: Low (DLL), Medium (DML) and High (DHL). Specified Lumen Output (SLO) packages available. Please see the SLO configurator at [ExtantLighting.com](http://ExtantLighting.com).

**LEDS** Latest generation of premium Nichia 3-step MacAdam Ellipse LED's available in (90+ CRI) 2700K, 3000K, 3500K, 4000K, or 5000K. LED modules are easily accessible and replaceable.

**VOLTAGE** Universal 120/277V (VU).

**BATTERY BACKUP** Factory provided low profile 10W battery for UL924 required 90-minute run time (optional).

**CONTROLS/SENSORS** Integrated controls are not available in the PDS System fixtures. Fixtures are sensor compatible and can be integrated into the fixture. Contact the factory for compatible sensors.

**FINISH** Standard finishes include silver anodized, powder coated white or powder coated black. Custom anodized and powder coated finishes available (RAL number matched). Canopy finishes are white, black or silver.

**CONTINUOUS ROWS** Innovative Toolless Latch System ensures simple installation. Seamless continuous rows with no lens breaks, pixelation or hotspots up to 400 feet with MEODF or 250 feet with MEOGC.

**PATTERNS** Standard Rectangle Pattern (R), U Pattern (U), and L Pattern (L) available.

**SUSPENSION** The PDS system supports fixtures and provides Class I low voltage power through a single cable. The non-conductive grippers combined with our highly flexible Kevlar reinforced twin conductor cord, cables, enable installation of adjustable suspension and power.

**MOUNTING** The PDS system allows for traditional mounting of the remote driver box above the power feed suspension point with a standard 5" canopy. 1/8" Silver Cord with Chrome-Plated Connectors.

**APPROVALS** UL and cUL Listed. Approved for Dry/Damp locations. Made in the USA. JA8 Compliant.

**LUMEN** Maintenance (L70) 70% of initial light output = Reported > 60,000 hours | Calculated > 200,000 hours (L90) 90% of initial light output = Reported > 60,000 hours | Calculated > 200,000 hours.

**WARRANTY** HTG 1 offered with a 5-year limited warranty. 5-year limited warranty covers LED, driver and fixture. For further details, refer to General Warranty and Obligations at [ExtantLighting.com](http://ExtantLighting.com).

**PATENTS** Extant Lighting's intellectual property is protected under Patent Pending Status by the U.S. Patent Office.

### Dimensions

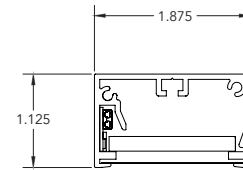

HTG-1P  
REMOTE

### Patterns

*Note: All miters/patterns shown and ordered in plan view.*

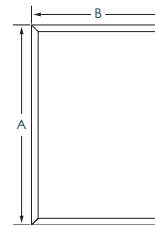

R\_\_X\_\_  
Rectangle  
Provide AxB  
Example: R6'x4'

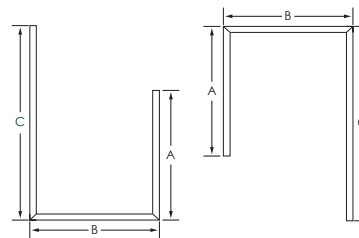

U\_\_X\_\_X\_\_  
U-Shape  
Provide AxBxC  
Example: U6'x4'x4'

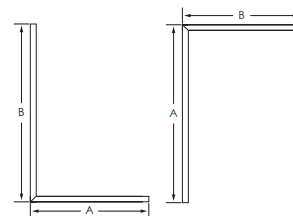

L\_\_X\_\_  
L-Shape  
Provide AxB  
Example: L6'x4'

**Microstructure EdgeTech Optics (MEO)™**

MEO™ Optics can be specified in direct and indirect orientation. Our innovative MEO™ design utilizes high efficiency Microstructure Lenses and Light Guide Plates for high optical extraction and precise light management. MEO™ delivers exceptional light quality with seamless illumination and uniformity with no pixelation, hot spots or lens breaks up to 400' or 250' with MEOGC continuous rows.

**DIRECT**

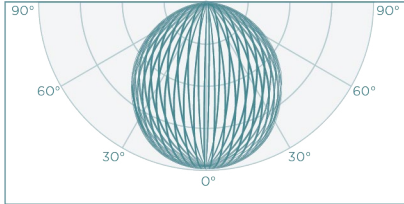

**MEO DF**  
LAMBERTIAN

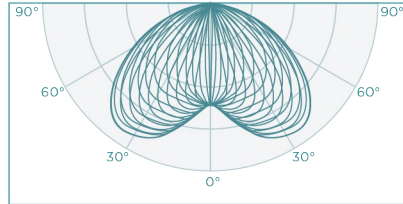

**MEO BW**  
BATWING

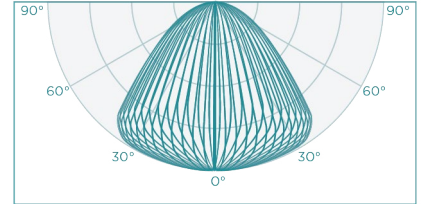

**MEO GC**  
GLARE CONTROL

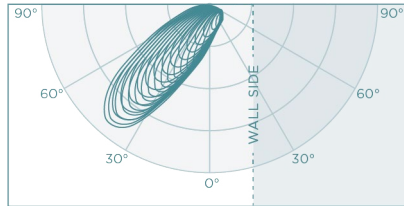

**MEO RF**  
ROOM FILL

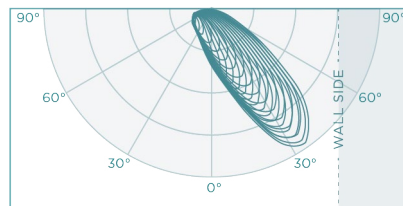

**MEO WW**  
WALL WASH



**Installation**

Thoughtful engineering is at the core of all of our fixture designs. All of our products are thoughtfully engineered and include innovative features that create a sophisticated fixture that is also contractor friendly and easy to install and service.

**PUSH AND EJECT SYSTEM**

Innovative “Push and Eject” System allows for toolless removal and installation of the Light Guide Plate. This thoughtful engineering creates easy access into the housing for simple installation and serviceability.

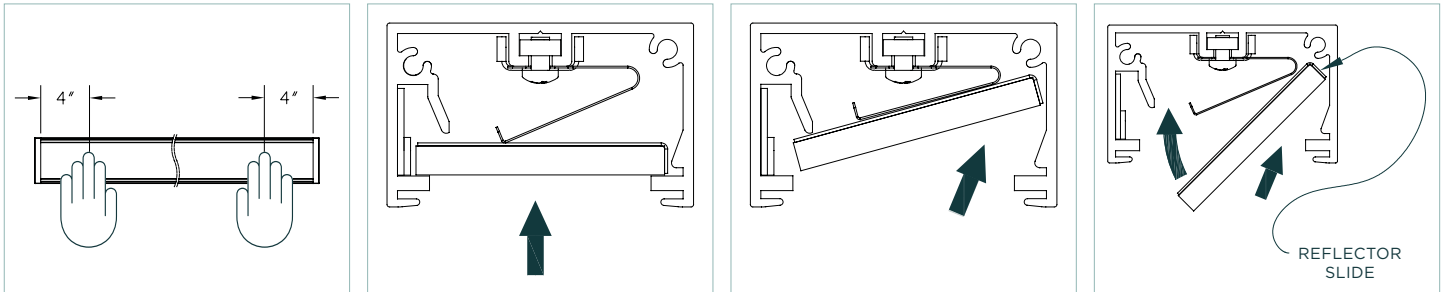

**TOOLLESS LATCH SYSTEM**

Our Toolless Latch System is designed to securely connect the extrusions of the continuous runs without the use of any tools, screws or external parts. Our innovative design allows the contractor to perfectly align the extrusion with the built-in alignment pins and cinch up the extrusion with the Toolless Latch System for a tight fit. The Toolless Latch System eliminates gaps and ensures perfect alignment.

**POWER DOWN SUSPENSION**

Single Switching

