



Huntington 1 Series

HTGDU-1W

ROTATIONAL ARM

Brilliant by Design™, minimalistic aesthetic combined with our innovative Microstructure EdgeTech Optics (MEO)™ will bring your vision to light. The innovative MEO™ design utilizes high efficiency Microstructure Lenses and Light Guide Plates for high optical extraction and precise light management.

FEATURES

- Innovative Microstructure EdgeTech Optics™ delivers unparalleled optic control and exceptional performance with seamless illumination and uniformity. Specify Narrow Distribution for Wall Wash applications or Diffused (Lambertian).
- MEO™ allows for minimalistic 1.5" aperture fixtures with extremely low profiles.
- PRO optics available with Ceiling Wash, Wall Wash and Diffusing distributions.
- Individually controlled Direct and Indirect optics and lumen outputs.
- Innovative Toolless "Push to Eject" System allows for easy installation and serviceability.
- Rotational Arm Mounting, 361° Locking Rotational arm hubs.
- Beautifully machined end caps and matching arm hardware.
- Custom powder coat finishes available.
- Specified Lumen Outputs (SLO) available up to 1480 lm/ft.
- 90+ CRI as a standard with Tunable White available.
- Proudly crafted in Huntington Beach, CA - USA.
- BABA compliant in most configurations. Consult factory for details.

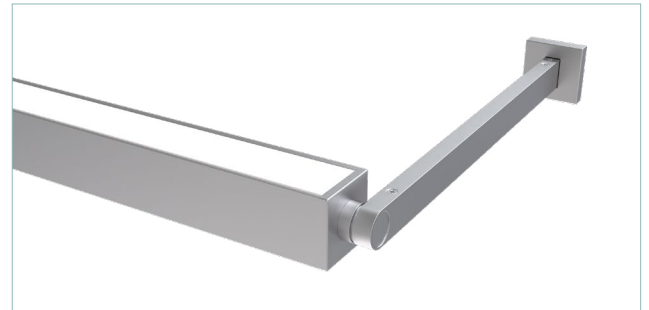

Performance Overview

4' Huntington 1 Direct - 3500K 90CRI MEODF				
Lumen Output	LL (Low)	ML (Medium)	HL (High)	SLO* (Specified)
Delivered Lumens	772	1908	3760	772-5920
Consumed Wattage	15	36	76	14.6-131.1
Efficacy (lm/w)	105	105	99	90-105
SDCM	3	3	3	3
*Specified Lumen Output (SLO) available in customizable lumen configurations (772 lm - 5920 lm). See SLO Configurator HERE				

**EXTANT ARCHITECTURAL LIGHTING™**15161 Triton Lane, Huntington Beach, CA 92649 | ☎ 714-362-8099 | ExtantLighting.com

* Due to our culture of always striving for product enhancement, specifications and information within this document are subject to change without notice. 2020 Extant Lighting, Inc. All rights reserved.

ORDERING INFORMATION

Project: _____

Date: _____ Type: _____

Product Family	Driver Location	Length	Direct Lumen Output	Direct Optics	Indirect Lumen Output
HTGDU-1W Huntington Series Direct Indirect 1.5" Aperture (Wall Mount)	TD Integral Driver RD Remote Driver	___ Specify Length*	DLL Low (193 lm/ft @ 1.84 lm/w)* DML Medium (477 lm/ft @ 4.55 lm/w)* DHL High (940 lm/ft @ 9.46 lm/w)* SLO-XX Specified Lumen Output available.**	MEO MEODF Diffusing MEOGC Narrow Distribution	ULL Low (193 lm/ft @ 1.84 lm/w)* UML Medium (477 lm/ft @ 4.55 lm/w)* UHL High (940 lm/ft @ 9.46 lm/w)* SLO-XX Specified Lumen Output available.**
Decorative open ceiling remote drivers available. Consult factory for spec code & details.	*Minimum Integral Driver length is 2'. Minimum Remote or In-Canopy Driver can be shorter, consult factory. *Custom length fixtures can be ordered in 3" increments. *Any length over 8" requires multiple fixture segments. See Continuous Row Drawing on product webpage.		*Delivered lumen output & consumed wattage based on "MEODF 35" (90 CRI - 3500K). See SLO Configurator for alternate outputs. **See SLO Configurator at ExtantLighting.com for appropriate "XX" output.		*Delivered lumen output & consumed wattage based on "MEODF 35" (90 CRI - 3500K). **See SLO Configurator at ExtantLighting.com for appropriate "XX" output.

Indirect Optics	Color Temp	Voltage	Driver	Finish	Options
MEO MEODF Diffusing MEOGC Narrow Distribution PRO* PROAY-WW Wall Wash PROAY-CW Ceiling Wash PRODF Diffusing	27 2700K 30 3000K 35 3500K 40 4000K 50 5000K TW 2700K-6500K (85+ CRI) XX Optional Color Temp & CRI Available	VU 120V-277V V3 347V	D* 1% 0-10V DN Non Dim DELV 1% Electronic Low Voltage Dimming (Reverse Phase dimming-120V only) DTRIAC 1% Electronic Low Voltage Dimming (Forward Phase dimming-120V only) DL1 Lutron Hi-Lume 1% EcoSystem DE 1% 0-10V DD1 1% DALI DDE 1% DALI DMX 1% DMX/RDM DTW 1% 0-10V Tunable White DT8 1% DALI Tunable White XX Other (Please Specify) *Dim to Off available. Please Specify "OFF" next to driver option if required.	SA Powder Coated Silver Anodized* WP Powder Coated Matte White* BP Powder Coated Matte Black* CC Powder Coated Custom** SAMF SA Housing/Machine Finish End Caps WPMF WP Housing/Machine Finish End Caps BPMF BP Housing/Machine Finish End Caps CCMF CC Housing/Machine Finish End Caps *The housing finish & end cap finish will match. **Custom Color (CC) to be provided in satin finish & color to be specified by a RAL number. The housing finish & end cap finish will match.	EMC_ Emergency Circuit(s)* EMB_ Emergency Battery Pack(s)* SOC Occupancy Sensor* SDL Daylight Sensor* MTC Multiple Circuit(s) (Daylight, Occupancy, Zone Specific)* BCS Brilliant Communications Solutions (wired/wireless)* 2C 2 Circuit (Direct Light and Indirect Light Controlled Independently) JA8 JA8 Compliant *EMC: Specify quantity of emergency circuits per run. *EMB: Specify quantity of battery packs per run. Minimum 4' unit. *SOC & SDL: Specify spacing/location of sensor(s). *MTC: Circuit location(s) to be identified through factory supplied drawings *BCS: Includes wired & wireless integration from our partners at nLight™, enlightened, Legrand, Crestron, Osram, Lutron & many more.

Mounting	Arm Length	Coverplate
WR WR Wall Mounted Rotational Arm (1" Rotational Hub)	L3 3" L6 6" L9 9" L12 12"* L18 18"* L24 24"* L___ Custom Length*	NC No Coverplate 4R 4" Round Coverplate* 4S 4" Square Coverplate* 2R 2-1/2" Round Coverplate* 2S 2" Square Coverplate*
	*All arm lengths 12" or greater require cable tie backs.	*Mounting hardware and arm match fixture finish

Specifications

CONSTRUCTION One-piece heavy gauge 6063 extruded aluminum housing. Precision-machined aluminum end caps.

OPTICS Microstructure EdgeTech Optics (MEO)™ utilizes high efficiency Microstructure Lenses and Light Guide plates for high optical extraction and precise light management. Specify Narrow Distribution or Diffused (Lambertian). Precision Refractive Optics (PRO) also available in Wall Wash, Ceiling Wash, and Diffused for indirect mounting direction.

LIGHT OUTPUT (3) Standard individually controlled (Indirect & Direct) lumen packages are available: Low (ULL/DLL), Medium (UML/DML) and High (UHL/DHL). Specified Lumen Output (SLO) packages available. Please see the (SLO) configurator at ExtantLighting.com.

LEDs Latest generation of premium Nichia 3-step MacAdam Ellipse LED's available in (90+ CRI) 2700K, 3000K, 3500K, 4000K, and 5000K. Tunable White available. LED modules are easily accessible and replaceable.

VOLTAGE Universal 120/277V (VU) and 347V (V3) available. Consult factory for driver options when 347V is specified.

EMERGENCY BATTERY Factory provided low profile 10W emergency battery for UL924 required 90-minute run time.

FINISH Standard finishes include powder coated silver, powder coated matte white or powder coated matte black. Custom powder coated finishes available (RAL number matched).

MOUNTING Wall mount rotational arm with 1" - 361° locking rotational hub.

APPROVALS UL and cUL Listed. Approved for Dry/Damp locations. Made in the USA. BABA compliant in most configurations. JA8 Approved.

LUMEN MAINTENANCE (L70) 70% of initial light output = Reported > 60,000 hours | Calculated > 200,000 hours (L90) 90% of initial light output = Reported > 60,000 hours | Calculated > 200,000 hours.

WARRANTY All Extant fixtures offered with a 5-year limited warranty which covers LED, driver and fixture. For further details, refer to General Warranty and Obligations at ExtantLighting.com.

PATENTS Extant Lighting's intellectual property is protected under Patent No. US 11,378,262 B2 and 12,007,101 B2 by the U.S. Patent Office.

Wall Mount/Tie Back

All arm lengths 12" or greater require cable tie backs.

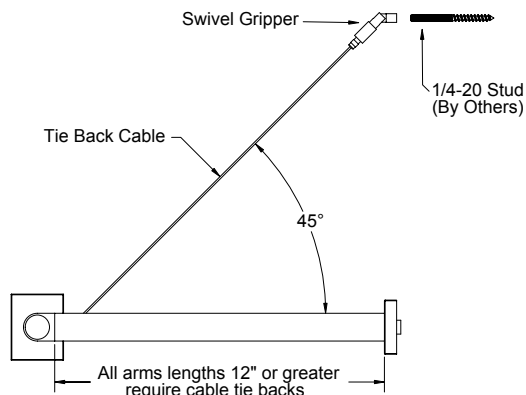

Dimensions

See installation instructions for more detail on mounting brackets

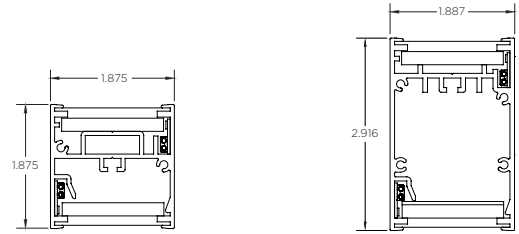

HTGDU-1W REMOTE

HTGDU-1W INTEGRAL

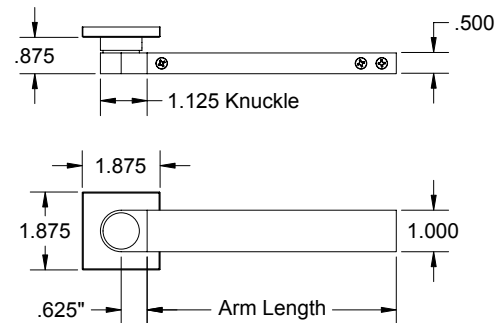

ROTATIONAL ARM
REMOTE

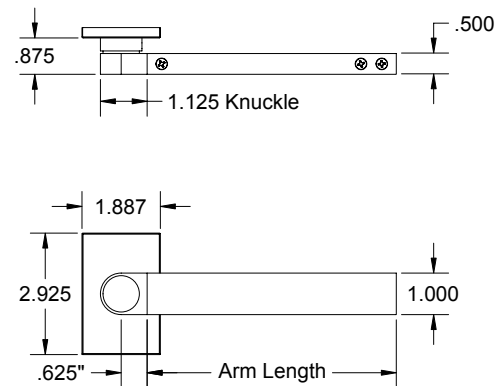

ROTATIONAL ARM
INTEGRAL



Microstructure EdgeTech Optics (MEO)™

Our innovative MEO™ design utilizes high efficiency Microstructure Lenses and Light Guide Plates for high optical extraction and precise light management. MEO™ delivers exceptional light quality with seamless illumination and uniformity with no pixelation, hot spots or lens breaks up to 250' continuous rows.

DIRECT

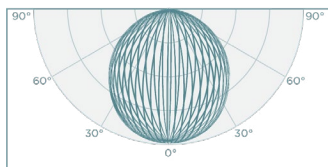

MEO DF
LAMBERTIAN

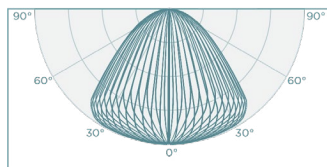

MEO GC
NARROW DISTRIBUTION

INDIRECT

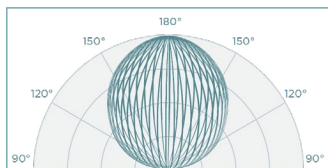

MEO DF
LAMBERTIAN

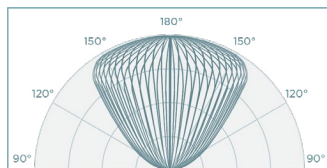

MEO GC
NARROW DISTRIBUTION

Precision Refractive Optics (PRO)

Precision Refractive Optics (PRO) are designed to produce precise optic control for diverse design applications. PRO utilizes the latest in extruded lens technology that mount directly to the LED board channel to give optimum control.

Please Note: The PRO optics are not a diffused light source. LED pixelation will be seen with this optic choice. If you want a completely diffused light source with no pixelation or hot spots, see our Microstructure EdgeTech Optics (MEO)™ options. PRO optics are the more cost effective indirect solution.

INDIRECT

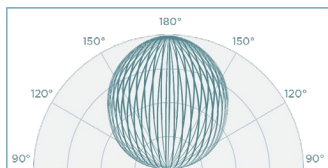

PRO DF
LAMBERTIAN

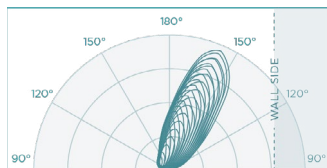

PRO AY-WW
WALL WASH

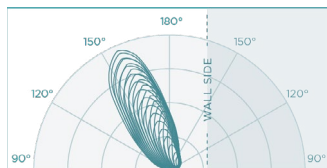

PRO AY-CW
CEILING WASH



Installation

Thoughtful engineering is at the core of all of our fixture designs. All of our products are thoughtfully engineered and include innovative features that create a sophisticated fixture that is also contractor friendly and easy to install and service.

PUSH TO EJECT SYSTEM

Innovative “Push to Eject” system allows for toolless removal and installation of the Light Guide Plate. This thoughtful engineering creates easy access into the housing for simple installation and serviceability.

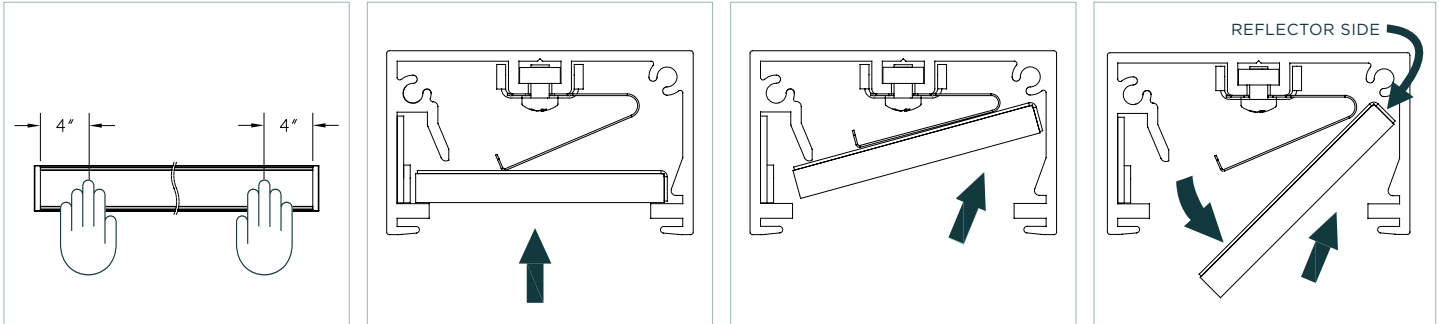

MEO™ OPTIC

MEO™ design utilizes high efficiency extraction and precise light management. MEO™ lens must be installed to ensure proper performance.

